

RL-W20 Manual Water Purifier User Manual

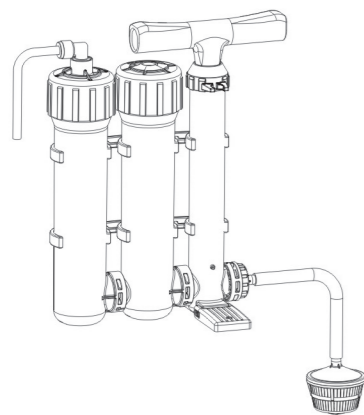

Application:

This product is mainly used for outdoor operations, hiking, emergency rescue, disaster prevention reserves, camping exploration, or daily water in remote areas without safe water sources.

OWRX.466.742
Rev.A. 2009

1. Notice

● This water purifier must use special parts or accessories from the manufacturer, otherwise, the company will not bear any responsibility for any quality problems, performance degradation or property losses caused by not using spare parts from the manufacturer.

● Manual water purifier, due to the particularity of the place of use, all the components constituting this product have a certain service life. The recommended service life of key parts and components are detailed in the "User Manual", please replace components strictly according to the requirements.

● The "User Manual" is a guiding document for the correct use of this product. The user should strictly follow the "User Manual" for operation, daily inspection and maintenance.

● This product is applicable for surface water or groundwater of Class III and above, for example, water sources such as flowing streams and lakes without chemical pollution. It is not suitable for water sources in areas with chemical polluted.

The company will not bear any responsibility for the consequences caused by operation not in accordance with the above precautions.

1.1. Products Features

● Adopt the high-precision PP cotton and ultrafiltration membrane, can remove 99.9% of pathogenic bacteria in the water;

● The filter element is quickly connected and installed, which is convenient to replace and clean;

● With the design of large suction manual pressure pump, the suction range can reach 2 meters, which can easily cope with various environments in the field.

● The manual pump uses a high-precision micro-pressure drop ceramic core check valve, which is better adapted to various impurities in the water and is not easy to fail.

1.2. Parameter

Item	Requirements
PP Cotton Filtration Accuracy	5 μ m
Ultrafiltration Filtration Accuracy	0.01 μ m
Purified Water Flow	1.5L/min
Suction Range	2 meters

Purified Water Flow	Surface water or groundwater of Class III and above
Outlet Water Quality: Conform to the regulations (2001) of "Safety and Function Assessment for Drinking Water Treatment Device—General Treatment Device".	

Note: In the water production process, the manual pump should not be operated too frequently because of the buffer time required for water absorption and discharge.

1.3. Process

Water Source—PP Cotton—Ultrafiltration Membrane—Purified Water

1.4. Product Structure

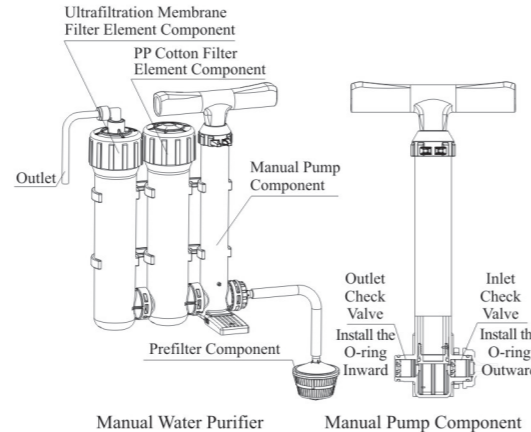

Manual Water Purifier Manual Pump Component

Dimensions: 281*78*345mm (This size is the size after packing.)

2. Product Use and Maintenance

2.1 Install and Use

Install the prefilter component of the inlet: Before using the machine, install the prefilter system of the inlet. Cut out an appropriate length of silicone tube for inlet (no longer than 2 meters), use a clamp on one end of the silicone tube (to prevent the prefilter component falls off during work) to fix it on the connector of the prefilter component, and the other end of the silicone tube is inserted into the inlet of the water pump. (Figure 1)

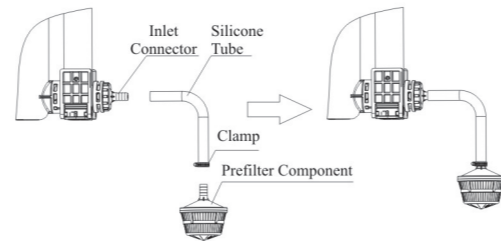

Figure 1 Install the Prefilter Component of the Inlet

Tips: During use, because there are many unknown impurities at the bottom of the water, try not to let the prefilter component sink into the bottom of water to prevent the filter element from blocked quickly.

Install the outlet pipe: Cut out a proper length of outlet pipe and install it into the outlet connector forcefully. Under normal circumstances, the outlet pipe enters about 20mm. (Figure 2)

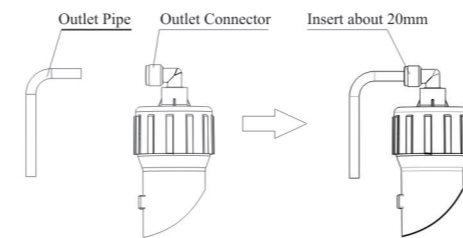

Figure 2 Install the Outlet Pipe

2.2 Filter Element Maintenance

The replacement cycle of the filter element will vary greatly depending on the water quality. Under normal circumstances, if user finds that the water output is small and it is hard to push manual pump, user could consider to replace the filter element.

Disassembly and Assembly of PP Cotton Filter Element

Rotate the PP cotton filter element component to a suitable angle, loosen the cover of the filter bottle counterclockwise with the matched wrench, and take out the PP cotton filter element. (Figure 3)

When reinstalling the new PP cotton, pay attention that the

inner center hole of the PP cotton must be aligned with the positioning post in the filter bottle, as shown in Figure 4.

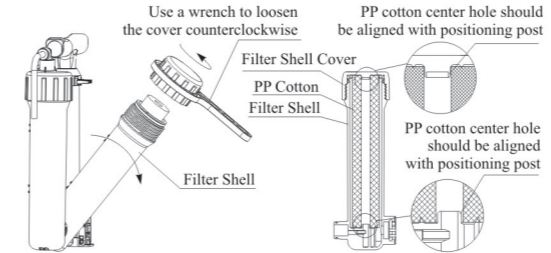

Figure 3 Loosen the filter bottle cover with a wrench

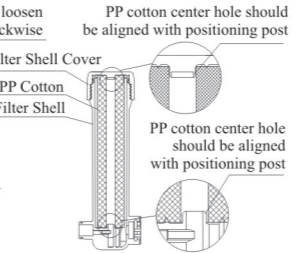

Figure 4 Note that the inner hole of PP cotton must be aligned with the positioning post

Disassembly and Assembly of Ultrafiltration Membrane

When there are dirty objects on the surface of the ultrafiltration membrane, in principle, it can be used after cleaning. When cleaning, the ultrafiltration membrane needs to be removed, and the membrane filaments are washed in clean water to clean the dirt on the surface. If the water output does not change after cleaning, the membrane pores may be blocked and the ultrafiltration membrane needs to be replaced.

The method of replacing the ultrafiltration membrane is similar to that of PP cotton. After loosening the cover of the filter bottle, take out the ultrafiltration membrane (Figure 5). If there is a water source, it can be pumped out by the water pressure of a manual pump (the operation of treating water).

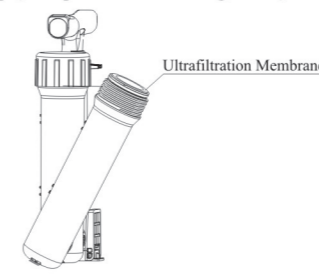

Figure 5

Disassembly and Assembly of Filter Element Component

The filter element component and the manual pump adopt a quick-connect structure, and must to match the buckle to remove or install it during installation, that is, the arrow and bulge between the filter bottles should correspond, as shown in Figure 6.

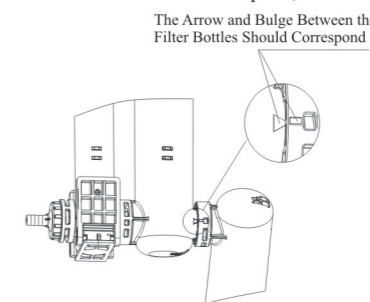

Figure 6 The filter bottle assembly or manual pump can be taken out at the position corresponding to the mark

Reminder: If the machine needs to be stored for a long time, please clean the residual water inside the machine, clean the filter element and dry before storing.

For machines that have not been used for a long time, please sterilize the inside of the machine before using it for the first time.

3. Assembly Parts List

Name	Quantity	Picture
Outlet PE Pipe	1 meter	
Inlet Silicone Tube	2 meters	
User Manual	1 piece	
Clamp	2 pieces	
Wrench	1 piece	

4. Trouble-Shooting

Problem	Cause	Correction
Water Leakage	Missing seal ring or not tightened.	Install the seal ring and tighten.
Outlet Water Flow Rate Becomes Smaller	PP cotton is blocked.	Replace PP cotton.
	Ultrafiltration membrane is blocked.	Clean or change the ultrafiltration membrane.
Does Not Absorb Water	Manual pump check valve is failure.	Clean or replace the check valve.