

## User Manual for Manual Backwash Disk Prefilter

OWRX.466.786  
Rev.A.2303

### 1.Main Application

Used for filtering municipal water treatment. Coarse filtration. Can filter PM larger than 0.05mm, for protecting the back water equipment. Suitable for installation in house.

### 2.Product Characteristics

- 1.Disk filter, inverted installation
- 2.High-efficiency backwash
- 3.With close function, no need to install ball valve in inlet.
- 4.Inlet and outlet could be rotated 360°
- 5.There is a check valve in the outlet to avoid backflow.
- 6.Comfortable hand feeling



### 3.Technical Parameters

Model	Nominal Size	Rated Water Flow m <sup>3</sup> /h	Rated Treated Water Quantity m <sup>3</sup>	Filtration Precision μm	Remark
RL-Q02	DN25	2.5	1500	50	Appearance BS
Operating Conditions:					
Working pressure:0.1~0.6MPa		Working water temperature :5~50℃			
Environment temperature:5~50℃;		Relative humidity:≤95% ( 25℃ )			

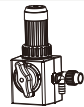

Note: Rated treated water quantity is related to raw water quality, the more grain particles containing, the less water quantity will be.

### 4.Check the Spare Parts

When unpacking the product, please check below spare parts.

Number	Description and Specification	Quantity	Remark
1	Prefilter	1	
2	Fixed Seat	1	
3	Expand Screw	3	

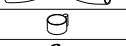
-1-

4	Sealing Ring	2	
5	Soft Pipeline	1	
6	Clamp	2	
7	Connector	1	

### 5. Product Appearance and Installation Dimensions

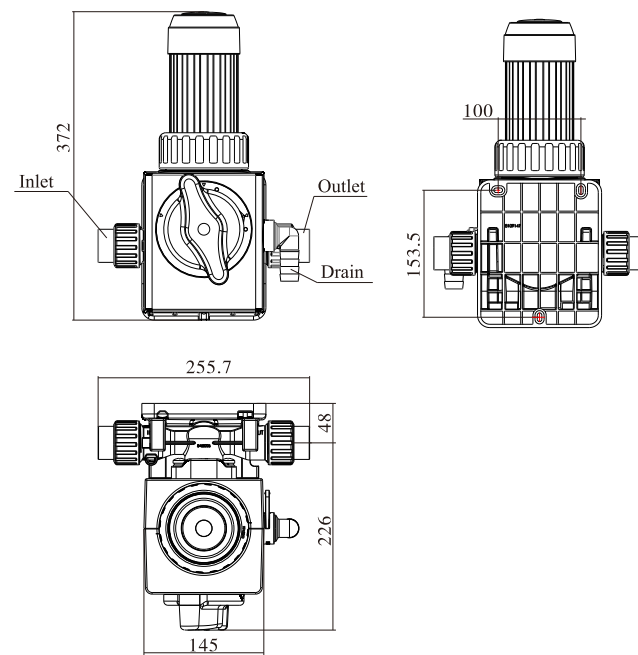

- Remark: 1. All dimensions above are in mm  
2. Inlet/Outlet 1"PPR, Drain Φ20  
3. Inlet/Outlet could be rotated 360° and vertical installation

### 6. Installation Notes

1. Installation conditions should conform to the requirements of the product work environment.
2. It should be installed after water meter, but in front of other equipment.
3. It should stay away from hydrops, no exposure to rain or sunlight.
4. If pipeline pressure changes suddenly, please install regulator valve.

-2-

5. The installation position of the drain connector must be lower than that of the product. As shown on the right.
6. Please avoid subsurface pipe when drilling during the installation of screw.
7. If you have any questions, please feel free to contact our after-sales service or professionals.

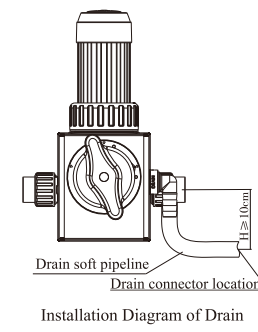

### 7. Installation Step

Before installation, be sure all these tools and materials listed below are ready. Electronic hand drill 1 piece (matching with Φ8 drill), cross screwdriver 1 piece, hammer 1 piece, pipeline clamp several pieces, thread seal tape several pieces.

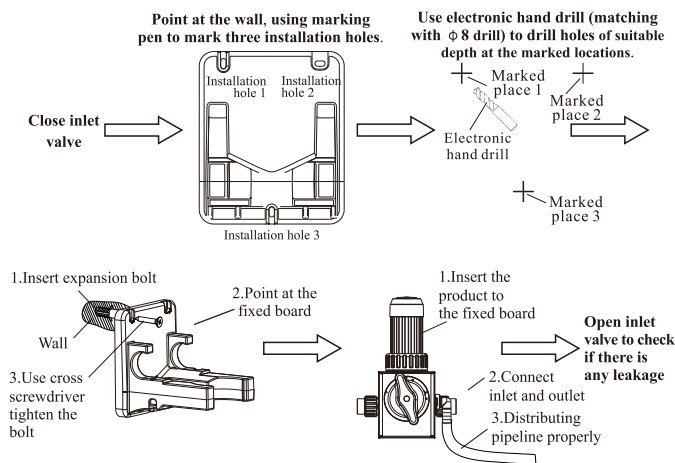

### 8.Working Position

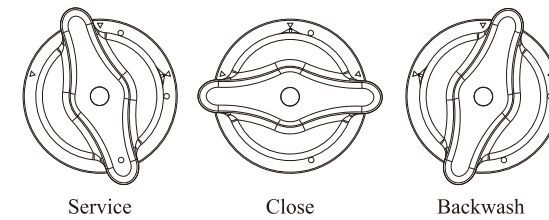

-3-

Under normal circumstances, when output water reach "Rated Treated Water Quantity" it start backwash, which continues 15-20 seconds. If the water quality is poor, the backwash times can be increased properly.

When the terminal equipment is under maintenance or new equipment is added, switch to "Close", for convenient operation and no need to control ball valve which installed in inlet.

### 9.Maintenance (suggested once a year)

Steps:

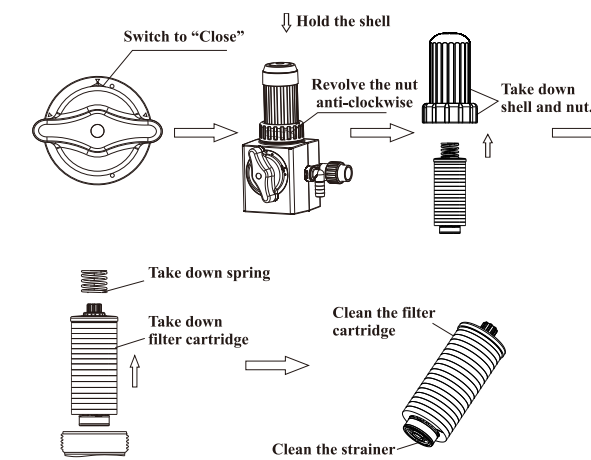

After clean, repeat above steps backward to assemble all the parts and check its seal for later use.

### 10. Pressure-Flow Rate Curve

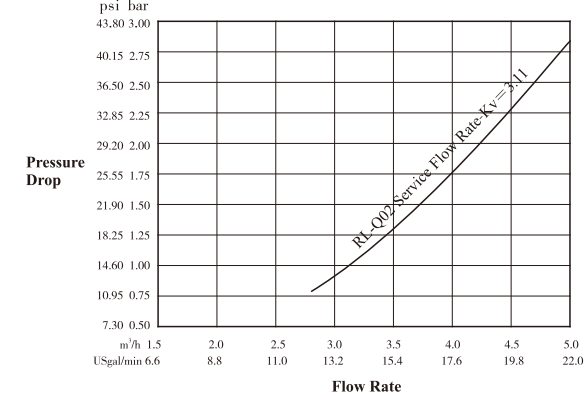

-4-

### 11. Warranty Card

Dear client:

This warranty card is the guarantee proof of Manual Backwash Disk Prefilter. It is kept by client itself, you could get the aftersales services from the supplier which is appointed by manufacturer. Please keep it properly. It couldn't retrieved if lost. It couldn't be repaired free of charge under the below conditions:

1. Guarantee period expired. (18 months).
2. Damage resulting from using, maintenance, and keeping that are not in accordance with the instruction.
3. Damage resulting from repairing not by the appointed maintenance personnel.
4. Content in guarantee proof is unconfirmed with the label on the real good or be altered.
5. Damage resulting from force majeure.

Product Name		Manual Backwash Disk Prefilter	
Model		Code of valve body	
Purchase Company Name		Tel/Cel	
Problem			
Solution			
Date if Repairing	Date of Accomplishment	Maintenance Man Signature	

When product need warranty service,please fill the form and send this card together with the product to the appointed suppliers.